

Packing draw

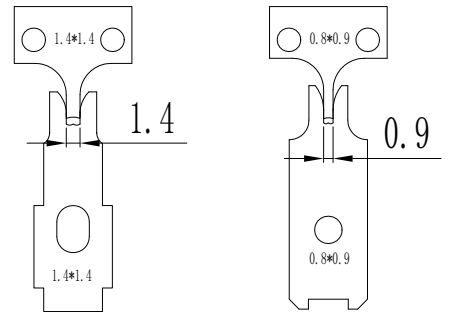

Recommend Crimping tool
AWG 26-28

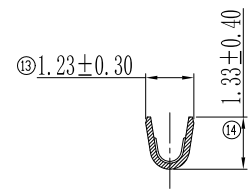

Section A-A

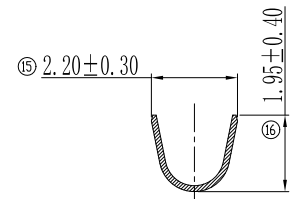

Section B-B

Unless otherwise specified tolerance:

X.	±0.50	X.°	±3°
.X	±0.38	.X°	±2°
.XX	±0.25		

Performance characteristics:

1. Main body part material
Contact terminal: Phosphor bronze, 1.27µm Min. Ni under plated, outer plating Sn 2.54µm Min..
2. Electrical requirements:
Current rating: 1 A
Voltage rating: 125 V
3. Mechanical requirements
Retention: ≥14.7N/Pin(14120254)
Wire gauge: AWG#26~28
4. Environment specification
Working temperature: -40°C~+105°C
5. Packing & storing
Method of packing: Paper reel
Storing condition: temperature of -10°C~+40°C
below 80% relative humidity
6. Style of installation: With the housing assembly
7. To prevent the pollution of the environment product info
RoHS agreement: In line with the European Union RoHS

Mark	NO.	File NO.	Signature	Date
DRAW			James Zhang	2019.12.13
CHK				
MAN			Tim	2020.02.13
STD			Juanli lai	2020.02.14
APP			Alan	2020.02.14

2.0 Board-In CONN Terminal

13463015

SLO.1346.024			
Projection	Rev.	Weight	Scale
	A0		
All Dimensions in mm		Sheet 1 of 1	
SHINNING SHENZHEN SHINNING ELECTRONIC CO.,LTD.			