

Part No.	Circuit	A	B	C	D
13432102	2	2.50	5.70	7.30	4.00
13432103	3	5.00	8.20	9.80	4.00
13432104	4	7.50	10.70	12.30	5.00
13432105	5	10.00	13.20	14.80	5.00
13432106	6	12.50	15.70	17.30	10.00
13432107	7	15.00	18.20	19.80	
13432108	8	17.50	20.70	22.30	
13432109	9	20.00	23.20	24.80	
13432110	10	22.50	25.70	27.30	
13432111	11	25.00	28.20	29.80	
13432112	12	27.50	30.70	32.30	
13432113	13	30.00	33.20	34.80	
13432114	14	32.50	35.70	37.30	
13432115	15	35.00	38.20	39.80	
13432116	16	37.50	40.70	42.30	
13432117	17	40.00	43.20	44.80	
13432118	18	42.50	45.70	47.30	
13432119	19	45.00	48.20	49.80	
13432120	20	47.50	50.70	52.30	

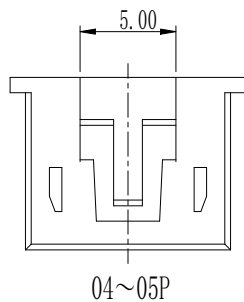
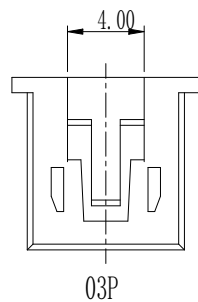
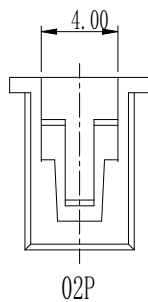

Unless otherwise specified tolerance:

X.	±0.50	X.°	±3°
.X	±0.38	.X°	±2°
.XX	±0.25		

Performance characteristics:

- Main body part material
Insulator: PA66 Black UL94V-0
- Electrical requirements:
Current rating: 3 A
Voltage rating: 250 V
Insulation resistance: $\geq 1000 \text{ M}\Omega$
Withstanding voltage: 800 Vr.m.s, 1mA, 60s
- Environment specification
Working temperature: $-40^{\circ}\text{C} \sim +105^{\circ}\text{C}$
- Packing & storing
Method of packing: plastic bag, inner box, outer box
Storing condition: temperature of $-10^{\circ}\text{C} \sim +40^{\circ}\text{C}$
below 80% relative humidity
- Style of installation: crimp cable installation
- To prevent the pollution of the environment product info
RoHS agreement: In line with the European Union RoHS.

Mark	NO.	File NO.	Signature	Date
DRAW		yongzhang		2022-02-21
CHK				
MAN			Tim	2022.05.30
STD			Juanli lai	2022.05.31
APP			Alan	2022.05.31

2.50mm Pitch wafer female Housing

134321XX

SL0.1343.065

Projection	Rev.	Weight	Scale
	A0		

All Dimensions in mm Sheet 1 of 1

