

1343-022-XX-X

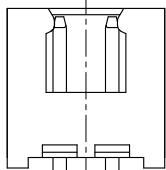

1343-026-XX-X

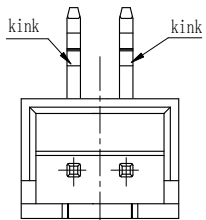

2PIN

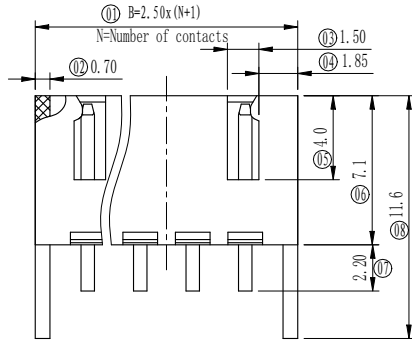

1343-XX2-XX-X

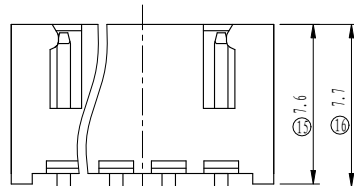

1343-XX6-XX-X

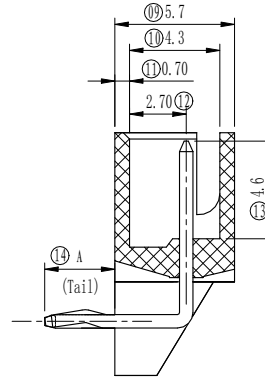

1343-XX2-XX-X

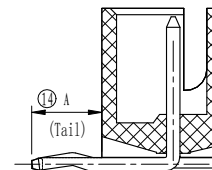

1343-XX6-XX-X

Performance characteristics:

- 1. Main body part material
  - Insulator: See part number rule
  - Contact terminal: Brass, 1.27~2μm Ni under plated, outer plating see part number rule

- 2. Electrical requirements:
  - Current rating: 3 A
  - Voltage rating: 250 V
  - Contact resistance: <10 mΩ
  - Insulation resistance: >1000 MΩ
  - Withstanding voltage: 1000 Vr.m.s, 1mA, 60s

- 3. Environment specification
  - Working temperature: -40°C ~ +105°C
  - Humidity: <93% at 40°C
  - Resistance to soldering heat: 260°C±5°C, 10s

- 4. Packing & storing
  - Method of packing: tray, small outer box
  - Storing condition: Temperature of -10°C ~ +40°C below 80% relative humidity

- 5. Style of installation: Solder PCB installation (THT)
- 6. To prevent the pollution of the environment product info
  - RoHS agreement: In line with the European Union RoHS.

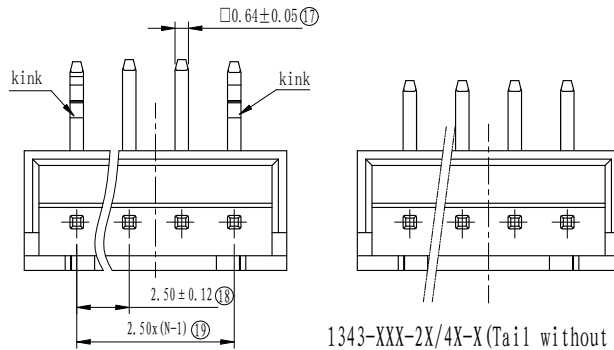

1343-XXX-2X/4X-X (Tail without Kink)

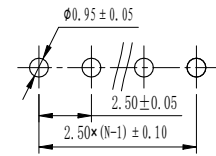

PCB Layout

1343 - XX X - X X - X

Series code	Terminal number	Spec code	Tail length code	Plating code	Insulator material & color
	02~15	Code Definition	Code Definition	Code Definition	Code Definition
		2 Right angle male with horn	1 A	B Sn 3~5 μm	3 LCP Black UL94Y-0
		6 Right angle male without horn	3 3.3	X Customized	N LCP Nature UL94V-0
		X Customized	2 2.2		X Customized
			4 4.3		
			4 2.6		
			X Customized		

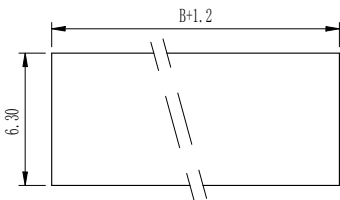

Ⓐ Recomende Panel Cutout  
Thickness: 6.0mm Max.  
Tolerance: ±0.10

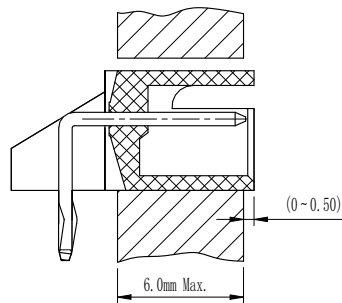

Unless otherwise specified tolerance:

X.	±0.50	X.°	±3°
.X	±0.38	.X°	±2°
.XX	±0.25		

Ⓒ	1	519336	JianBoLuo	2021.10.18
Ⓓ	1	245390	An.Cheng	2017.09.20
Ⓔ	1	201755	An.Cheng	2017.04.10
Mark	NO.	File NO.	Signature	Date
DRAW			An.Cheng	2015.06.11
CHK			Tim	2022.03.30
MAN				
STD			Juanli lai	2022.03.31
APP			Alan	2022.03.31

2.50mm Pitch wafer right angle male

1343-XXX-XX-X

SL0.1343.011

Projection	Rev.	Weight	Scale
	A3		

All Dimensions in mm Sheet 1 of 1

