

- Performance characteristics:
1. Main body part material
Insulator: LCP Black UL94V-0
Contact terminal: Copper alloy, 1.27 μm Ni under plated, outer plating see spec list
 2. Electrical requirements:
Current rating: 2 A
Contact resistance: ≤20 mΩ
Insulation resistance: ≥1000 MΩ
Withstanding voltage: 500 Vr.m.s, 1mA, 60s
 3. Mechanical requirements
Retention force: ≥4.5 N/pin
 4. Environment specification
Working temperature: -40°C~+105°C
Humidity: ≤93% at 40°C
Resistance to soldering heat: 260°C±5°C, 10s
 5. Packing & storing
Method of packing: Tape&reel, outer box
Storing condition: temperature of -10°C~+40°C below 80% relative humidity
 6. Style of installation: SMT
 7. To prevent the pollution of the environment product info
RoHS agreement: In line with the european union RoHS.

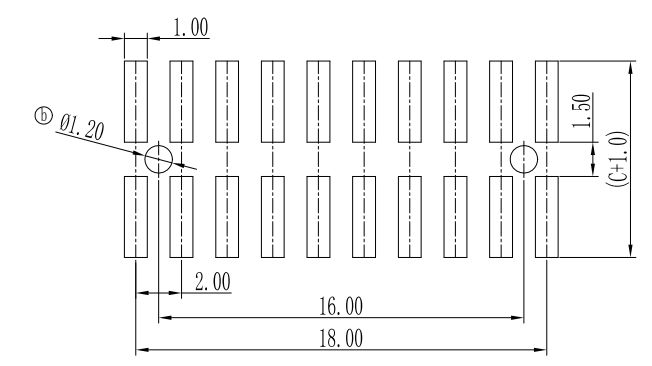

RECOMMEND PCB LAYOUT
Tolerance ±0.05

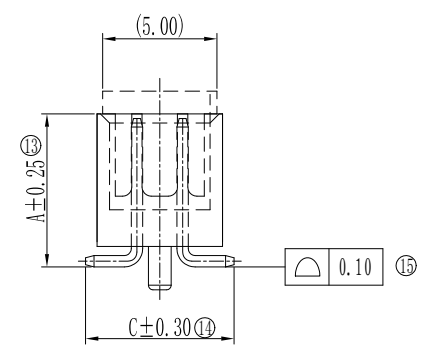
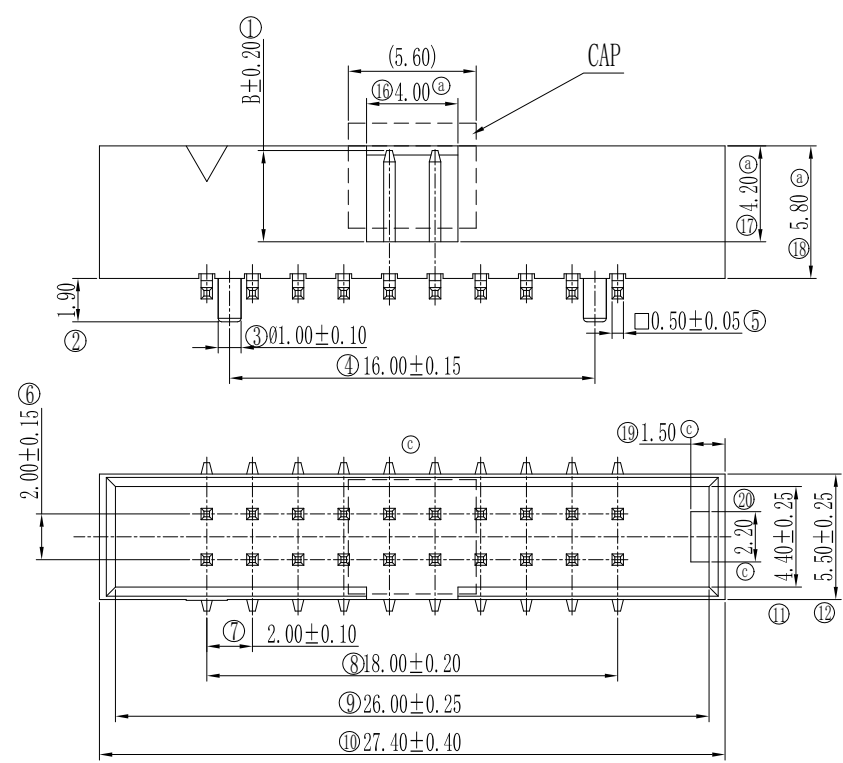
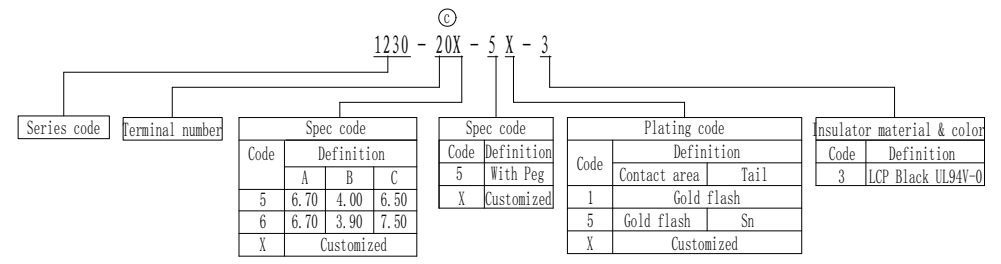

Unless otherwise specified tolerance:

X.	±0.50	X.°	±3°
.X	±0.38	.X°	±2°
.XX	±0.25		

①	5	456973	James Zhang	2021.02.27
②	1	307351	Huanjiang Xu	2018.05.29
③	3	153152	Tim Lv	2016.09.29
Mark	NO.	File NO.	Signature	Date
DRAW			Tim Lv	2015.05.18
CHK			Tim	2022.05.06
MAN				
STD			Juanli lai	2022.05.07
APP			Alan	2022.05.07

2.00 Pitch Box Header SMT
(With Peg)
©1230-20X-5X-3

SLO. 1230.004			
Projection	Rev.	Weight	Scale
	A3		
All Dimensions in mm		Sheet 1 of 1	
SHINNING SHENZHEN SHINNING ELECTRONIC CO.,LTD.			