

Section A-A

Performance characteristics:

1. Main body part material
  - Insulator: see part number rule
  - Contact terminal: Brass Ni 1.27 μm Min. under plated,
  - Outer plating see part number rule
  - CAP: LCP Nature UL94V-0
2. Electrical requirements:
  - Current rating: 3 A
  - Contact resistance: ≤40 mΩ
  - Insulation resistance: ≥1000 MΩ
  - Withstanding voltage: ≥500 Vr.m.s, 1mA, 60s
3. Environment specification
  - Working temperature: -55°C~+105°C
4. Packing & storing
  - Method of packing: Reel
  - Storing condition: temperature of -10°C~+40°C  
below 80% relative humidity
5. Style of installation: SMT
6. To prevent the pollution of the environment product info  
RoHS agreement: In line with the european union RoHS.

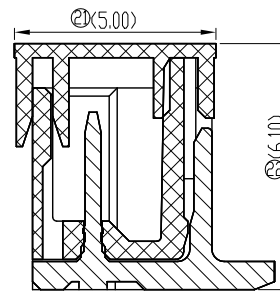
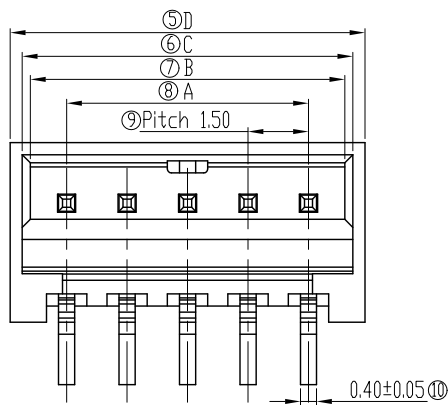

Section A-A

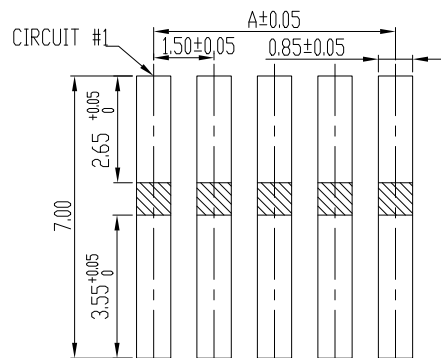

Applicable PCB Layout

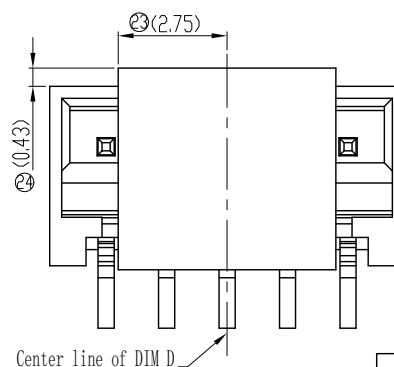

Unless otherwise specified tolerance:

X.	±0.50	X.°	±3°
.X	±0.38	.X°	±2°
.XX	±0.25		

①	1	457089	An.Cheng	2020.06.20
②	2	269902	Huanjiang Xu	2017.12.20
Mark	NO.	File NO.	Signature	Date
DRAW	An.Cheng 2013.09.24			
CHK	Tim 2020.06.05			
MAN				
STD	Juanli lai 2020.06.08			
APP	Alan 2020.06.08			

1.50mm Pitch SMT Wafer

① 1342-XX4-1X-X

SL0.1342.002

Projection	Rev.	Weight	Scale
------------	------	--------	-------



A2		
----	--	--

All Dimensions in mm Sheet 1 of 2



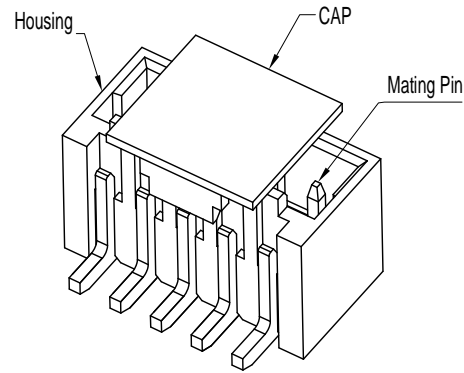

Circuit	A	B	C	D	E
2	1.50	3.30	3.70	4.30	1.70
3	3.00	4.80	5.20	5.80	3.20
4	4.50	6.30	6.70	7.30	4.70
5	6.00	7.80	8.20	8.80	6.20
6	7.50	9.30	9.70	10.30	7.70
7	9.00	10.80	11.20	11.80	9.20
8	10.50	12.30	12.70	13.30	10.70
9	12.00	13.80	14.20	14.80	12.20
10	13.50	15.30	15.70	16.30	13.70
11	15.00	16.80	17.20	17.80	15.20
12	16.50	18.30	18.70	19.30	16.70
13	18.00	19.80	20.20	20.80	18.20
14	19.50	21.30	21.70	22.30	19.70
15	21.00	22.80	23.20	23.80	21.20

1342-XX4-1B-X

Series code		Terminal number		Style of installation		Spec code		Plating code		Insulator material & color	
Code	Definition	Code	Definition	Code	Definition	Code	Definition	Code	Definition	Code	Definition
		02~15		4	SMT	1	With CAP	B	Sn	P	PA6T Nature UL94V-0
						X	Customized ①	1	GoldFlash	N	LCP Nature UL94V-0 ②
								X	Customized	X	Customized

Unless otherwise specified tolerance:

X.	±0.50	X.°	±3°
.X	±0.38	.X°	±2°
.XX	±0.25		

①	1	457089	An.Cheng	2020.05.20
②	2	269902	Huanjiang Xu	2017.12.20
Mark	NO.	File NO.	Signature	Date
DRAW		An.Cheng		2013.09.24
CHK				
MAN				
STD				
APP				

1.50mm Pitch SMT Wafer

①1342-XX4-1X-X

SL0.1342.002

Projection	Rev.	Weight	Scale
	A2		
All Dimensions in mm		Sheet 2 of 2	
SHINNING SHENZHEN SHINNING ELECTRONIC CO.,LTD.			