

- Performance characteristics:
- 1.Main body part material
Contact terminal: Copper Alloy, 1.27 ~ 2 μ m Ni under plated,
Outer plating Sn 3 ~ 5 μ m.
 - 2.Electrical requirements:
Current rating: 15 A
Voltage rating: 220 V AC
 - ③ 3.Environment specification
Working temperature: -40℃ ~ +125℃
Temperature rise vs current: ≤ 30℃
 - 4.Packing & storing
Method of packing: Reel
Storing condition: temperature of -10℃ ~ +40℃
below 80% relative humidity
 - 5.Style of installation: SMT
 - 6.To prevent the pollution of the environment product info
RoHS agreement: In line with the european union RoHS.

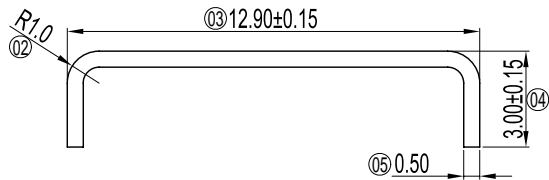

Reel packing:

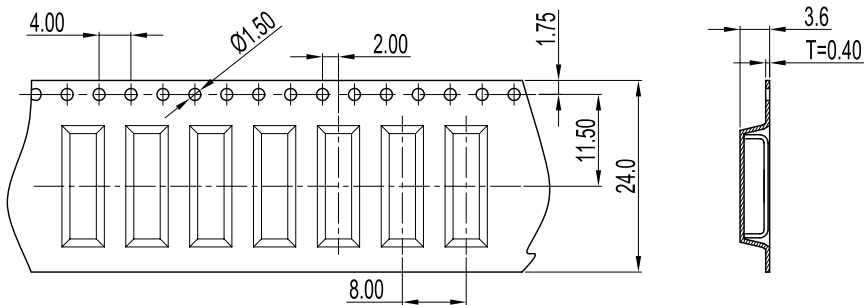

Note:

- 1.Number of packing: : 2500Pcs/Reel
- 2.Peel OFF force: 10.2gf ~ 130gf
- 3.Tape lead length:

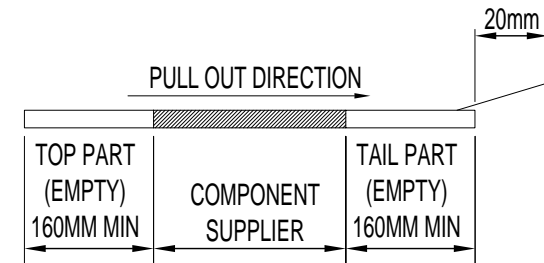

Convolute direction

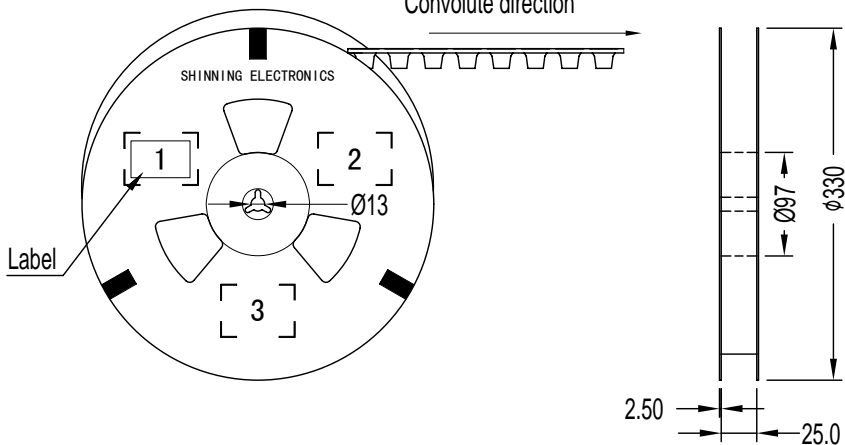

Unless otherwise specified tolerance:

X.	± 0.50	X.°	± 3°
.X	± 0.38	.X°	± 2°
.XX	± 0.25		

					SL0.1916.009					
					Right Angle Jumper Pin					
③	1	PCN-201412012	An.Cheng	2014.12.08			Projection	Rev.	Weight	Scale
Mark	NO.	File NO.	Signature	Date				A1		
DRAW	An.Cheng 2014-08-18									
CHK										
MAN										
STD										
APP										
					19163019					
							All Dimensions in mm Sheet 1 of 1			
							SHINNING SHENZHEN SHINNING ELECTRONIC CO.,LTD.			